

Apartment Type 2C	
Room Name	Area
Bathroom	4.19
Bedroom 1	13.41
Bedroom 2	11.84
Kitchen	7.26
Living Room	23.95
P.O.S	7.58
Store	3.39
Utility	4.31

1 Apartment Type 2C 1:50

Gross Floor Area: 81.42 m²
Combined Storage: 7.7 m²

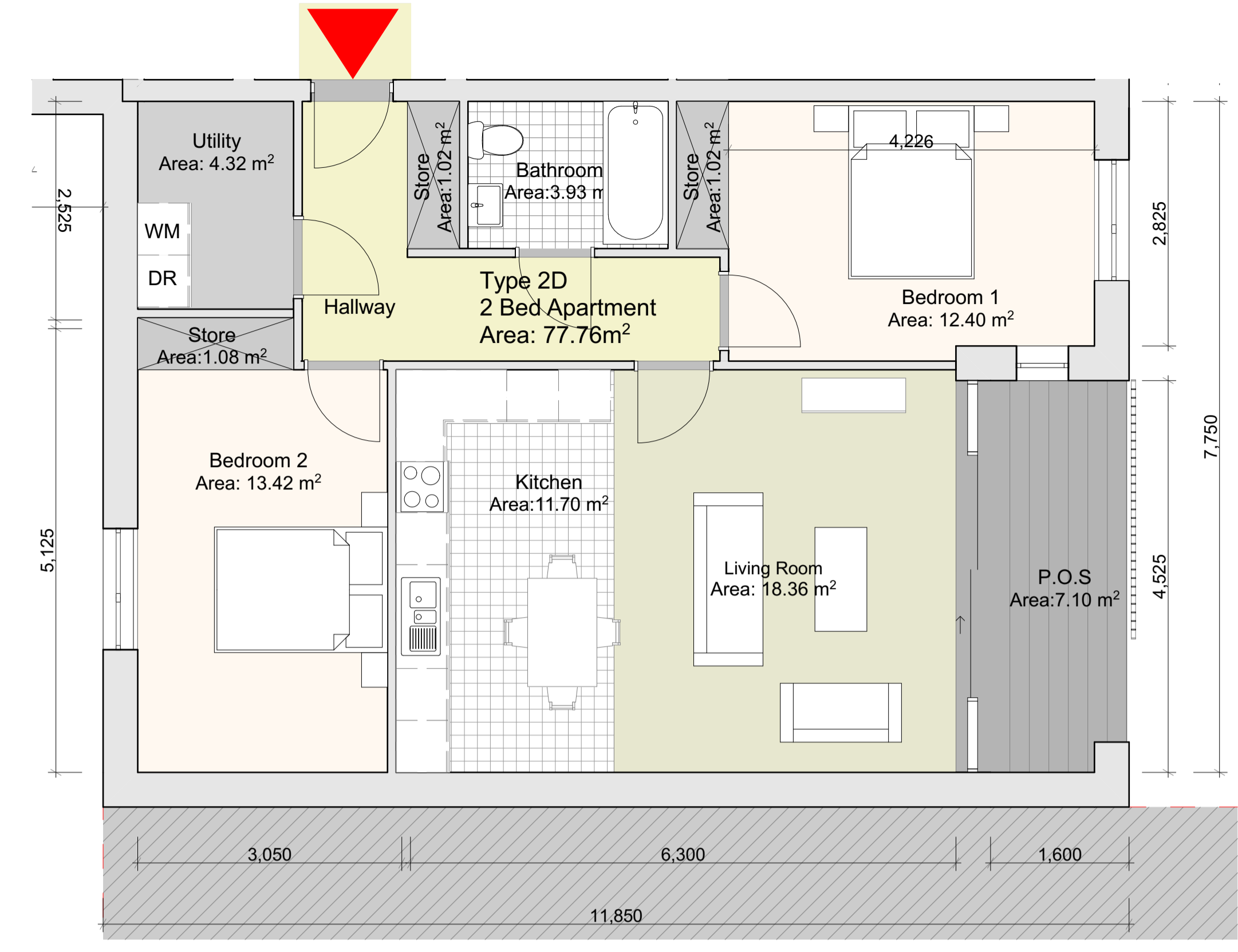

Apartment Type 2D	
Room Name	Area
Bathroom	3.93
Bedroom 1	12.40
Bedroom 2	13.42
Kitchen	11.70
Living Room	18.36
P.O.S	7.10
Store	3.12
Utility	4.32

2 Apartment Type 2D 1:50

Gross Floor Area: 77.76 m²
Combined Storage: 7.44 m²

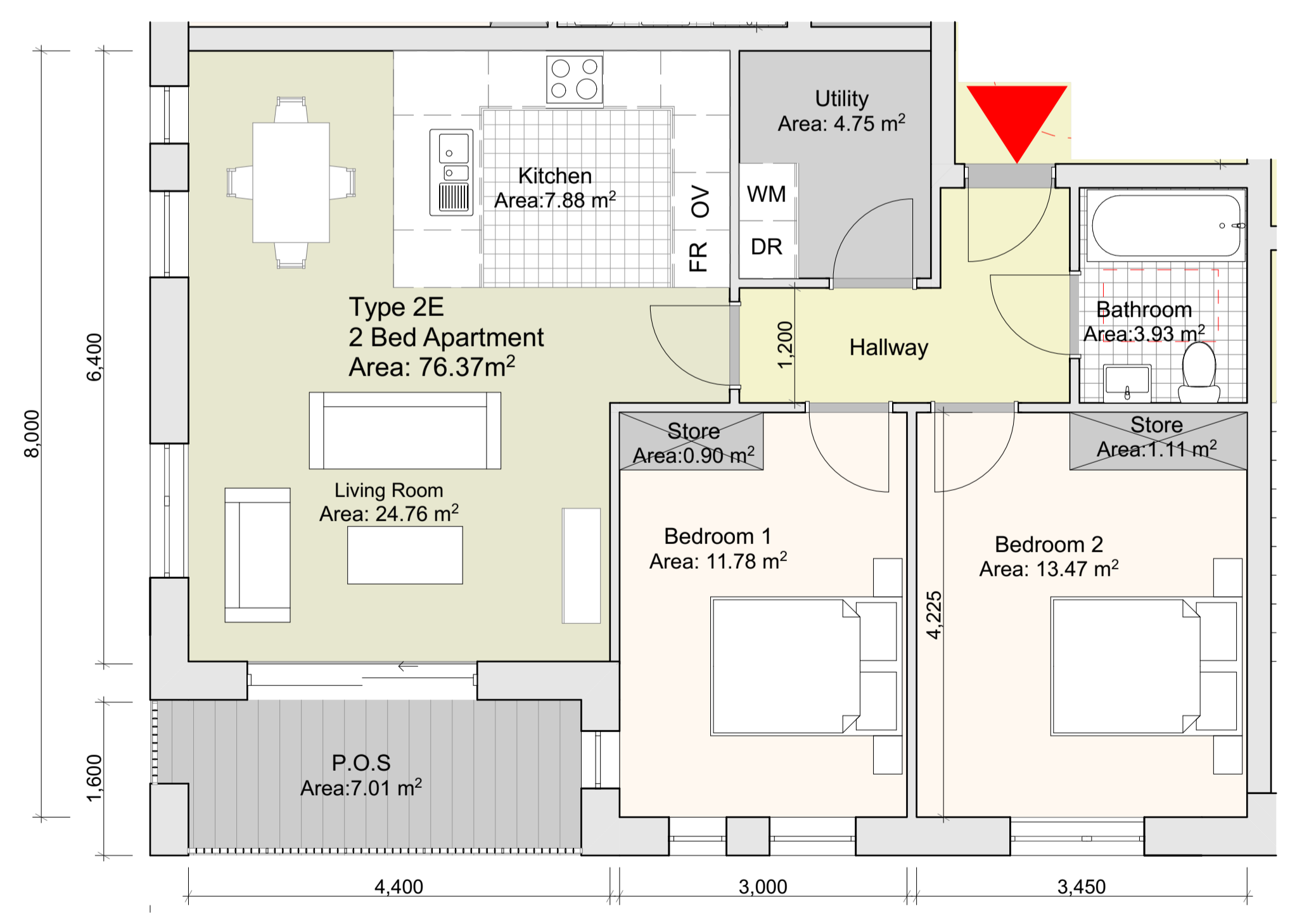

Apartment Type 2E	
Room Name	Area
Bathroom	3.93
Bedroom 1	11.78
Bedroom 2	13.47
Kitchen	7.88
Living Room	24.76
Store	2.01
Utility	4.75

3 Apartment Type 2E 1:50

Gross Floor Area: 76.37 m²
Combined Storage: 6.76 m²

CONDITIONS OF USE OF THIS DRAWING: This drawing shall be deemed to be accepted by the client on the date of issue of this drawing. It is the client's responsibility to ensure that the drawing is used for the purpose intended and that it is not used for any other purpose. The client shall be responsible for any errors or omissions in the drawing and for any consequences arising therefrom. The client shall be responsible for any costs incurred in connection with the drawing, including but not limited to the cost of reproduction, distribution, and storage. The client shall be responsible for any damage to the drawing or any loss of data. The client shall be responsible for any changes to the drawing and for any consequences arising therefrom. The client shall be responsible for any disputes arising from the drawing. The client shall be responsible for any legal action taken against the architect or any other party in connection with the drawing. The client shall be responsible for any costs incurred in connection with the drawing, including but not limited to the cost of reproduction, distribution, and storage. The client shall be responsible for any damage to the drawing or any loss of data. The client shall be responsible for any changes to the drawing and for any consequences arising therefrom. The client shall be responsible for any disputes arising from the drawing. The client shall be responsible for any legal action taken against the architect or any other party in connection with the drawing.

No.	Date	Comments	By

Scale: 1:50
Drawing Purpose: SHD Application
Project: Residential Development at Bothan an Choiste, Castlegar, Co. Galway
Client: Lock House Developments LTD.
Date: MAY 2022
Paper size: A1
CTB file:
Drawn by: JF
LTS file:
Checked by: JON
File path: