

01 Site Section 2-2 Part 01
Scale 1:200



02 Site Section 2-2 Part 02
Scale 1:200



03 Site Section 2-2
Scale 1:500

REFER TO ARCHITECT'S MASTER SITE LAYOUT PLAN 3004 FOR NORTH ORIENTATIONS.

THIS DRAWING TO BE READ IN CONJUNCTION WITH ARCHITECT'S DRAWINGS, CONSULTANT ENGINEER'S DRAWINGS & SPECIFICATIONS.

LEVELS GIVEN ON HOUSE TYPE DRAWINGS ARE GIVEN TO A LOCAL ABSOLUTE ZERO LEVEL. FOR SPECIFIC LEVELS DEPENDING ON INDIVIDUAL UNIT LOCATION, REFER TO ARCHITECT'S SITE LAYOUT PLAN (3003, CONTEXT SECTIONS AND ENGINEER'S DRAWINGS WHERE LEVELS ARE ALL GIVEN IN RELATION TO LAND SURVEYOR'S BENCHMARK BASED ON MALIN HEAD DATUM LEVEL.

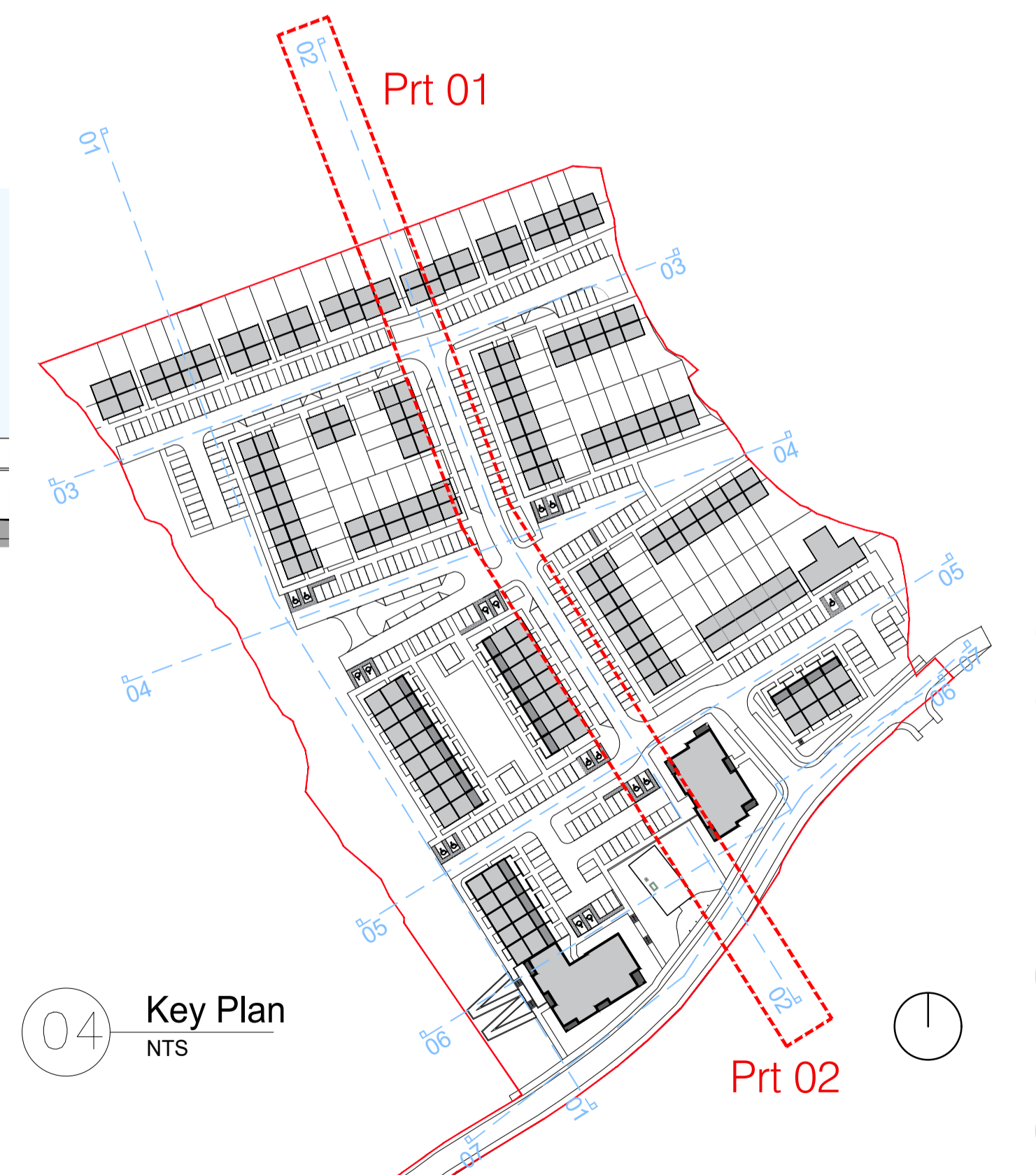

04 Key Plan
NTS

CONDITIONS OF USE OF THIS DRAWING: 1. The use of or reliance upon this drawing shall be deemed to be acceptance of these conditions of use unless otherwise agreed in writing, such written agreement to be sought from and issued by the Architects prior to the use or reliance upon this drawing. 2. O'Neill O'Malley Ltd, their agents, Architects, employees or directors shall not be liable for any loss damage or injury consequential or otherwise, however caused for failure to comply with any or all of these conditions. 3. This drawing, the design and contents contained herein are copyright, all rights reserved. No part hereof may be copied or reproduced partially or wholly in any form whatsoever without the prior written consent of the copyright owners O'Neill O'Malley Ltd. 4. The client is granted a copyright licence to use this drawing and its contents for the purpose of which the drawing has been prepared. If this drawing has been produced for construction purposes the licence will only be valid for a single three dimensional reproduction and shall expire once a single reproduction has occurred. Such a licence only passes to the Client on payment of Architects fees in full and in any event the licence cannot be assigned without the prior written consent of O'Neill O'Malley Ltd. 5. Do not scale off this drawing. Figured metric dimensions only should be taken off this drawing. Imperial dimensions, if any, contained on this drawing are given for illustration purposes only. 6. This drawing is to be relied upon only for the purposes for which it was prepared. This drawing is not to be relied upon for construction purposes and no implied or expressed warranty is given as to the suitability for construction purposes unless the drawing is stated to be for construction purposes. 7. All contractors, whether main or sub-contractors, must visit the site and are responsible for taking and checking any and all dimensions and levels that relate to the works. 8. Where this drawing contains discrepancies in relation to other relevant documents, such discrepancies shall be brought to the attention of the Architects who shall issue a written instruction as to which information is to be followed, and until such Architects instruction has been issued any work carried out on foot of the discrepancies shall be unauthorised. 9. References to National standards, whether to Irish (ISI British (BS) or otherwise, or codes of practice (CPI) shall be deemed to refer to the relevant standard or code current at the date of issue of the drawing notwithstanding any reference to the contrary or to any earlier standard. 10. Any reference to the "Architect" or "Architects" on this or any other relevant document shall be construed to apply to director of O'Neill O'Malley Ltd who has been nominated as the partner-in-charge or to the nominated project Architect but only while such Architect remains in the employment of O'Neill O'Malley Ltd. 11. Any questions as to the meaning or application of these conditions shall be submitted in writing to the Architect for his ruling and such a ruling shall be conclusive as to the meaning or application of these conditions. 12. All information shown relating to existing structure and construction detail is preliminary and subject to 'opening up' and confirmation by the contractor. Any discrepancies are to be referred to the Architect. 13. Proprietary items shall be fixed in strict accordance with manufacturer's instructions. 14. Sizes of proprietary items shall be checked with manufacturer and checked for compliance with design detail. 15. Contractor is responsible for procuring any proprietary items required specified with due attention to 'lead in' times ensuring compliance with programme dates.

No.	Date	Comments	By

REVISIONS

No.	Date	Comments	By

REVISIONS

Scale: 1:500, 1:200
Drawing Purpose: SHD Application
Project: Residential Development at Bothar an Choiste, Castlegar, Galway
Client: Lock House Developments LTD
Date: July 2022
Drawn by: IF
Checked by: JON
Paper size: A1
CTB file: 3.09
LTScale:

File Ref: 3.09
Subject: Section 2 - 2
RAIA
2022
03
P

O'NEILL
O'MALLEY
ARCHITECTURE

Project No. 18151
Drawing No. 3007
Rev. 01
Barracks Yard, James St, Westport, Co. Mayo, F28 K798
Unit 2, Galway Technology Park, Galway, H91 EPW0
T: +353(0)91 771033
E: info@onon.ie

Site Section 2-2